

USE

The controls are situated on the right hand side behind a lockable control cover that can be secured by a special security screw.

When the light on the independent On/Off switch is illuminated the appliance is heating. Once the electronic thermostat has been set to the required temperature it maintains a constant temperature.

The setting may vary from one room to another depending on the power of the convector in relation to the characteristics of the room. It should be adjusted to suit personal temperature requirements.

If a minimum temperature is required in a room (anti-frost protection = about 7°C), for instance in an unoccupied room, set the thermostat switch to a minimum position (*).

ELECTRONIC CONTROLS

The electronic thermostat for this appliance has been designed to give you maximum economy and comfort.

Control Box:

- All the controls are behind a lockable front cover.
- Separate On/Off switch (On is indicated by a light)
- Electronic thermostat



PROGRAMMING FACILITIES

Connecting the appliance to a remote programmer through the supplied black pilot wire can program this heater.

Programmable positions: Comfort, Economy, Anti-frost and Stop

Model	Rating Watt	Height mm	Length mm	Depth mm	Weight kg
7373-1	500	425	390	93	7
7373-2	750	425	540	93	8
7373-3	1000	425	540	93	8
7373-4	1250	425	720	93	11
7373-5	1500	425	720	93	11
7373-6	1750	425	870	93	12
7373-7	2000	425	870	93	12
7373-9	3000	425	1170	93	15

POSITION

The appliance should be mounted in an horizontal position on the wall brackets supplied.

For maximum efficiency this appliance should be positioned so that the heat given off mixes with the maximum volume of air. It can be installed in all rooms, including damp situations in bathrooms, outside of the restricted zones in accordance with current regulations.

If the appliance is installed in a bathroom, it must be located in a position where a person in the bath or shower cannot touch the controls. A 30mA circuit breaker should protect the power supply.

IMPORTANT

The air inlet and outlet grilles must not be partially or totally blocked to avoid operating problems or damage to the appliance.

BATHROOM INSTALLATION

These heaters are splash proof to IP24 standard.

FIXING

Remove the wall-mounting bracket from the packaging and fix it to the wall with 4 to 6 screws (6 screws required for 1250W plus).

To make it easier to obtain the minimum base of unit to floor clearance measurement, place the mounting bracket against the wall with the bottom clips on the floor and mark the lower holes drill position through the central holes. Having fixed the mounting bracket to the wall, hang the appliance on the upper hooks of the mounting bracket by slipping the appliance over the hooks from the top to the bottom. Line up the lower holes and hooks on the bracket to meet exactly. Fix the appliance on its mounting bracket using the 2 screws that were removed from the appliance.

ELECTRICAL CONNECTION

In accordance with IEE regulations, a competent electrician must carry out installation of this appliance.

No disassembly is required for connecting the convector to the mains. Use the original 1.2m flexible wire that is to be connected to the mains by means of a connecting box. The fixed installation should have an omni polar circuit-breaking device with a contact opening distance of at least 3mm.

The flexible wire should be connected into a fused spur box to the mains.

The black pilot control wire is designed only to carry a signal from a compatible remote programmer or switching device.

If the black pilot wire is not being used with a compatible programming or switching device it should be terminated and insulated within the fused spur.

WIRING DIAGRAM

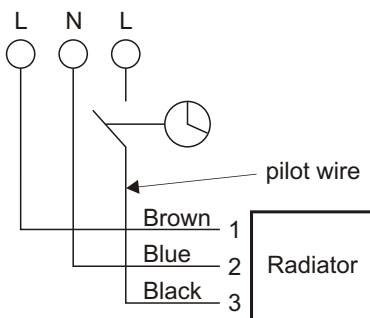

MINIMUM CLEARANCES

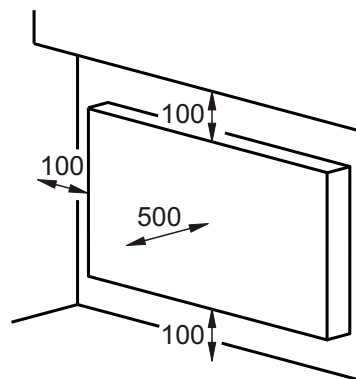

FIXING DIMENSIONS

viewed from front
cable entry on right

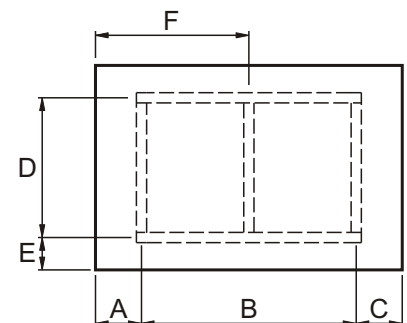

Model	A mm	B mm	C mm	D mm	E mm	F mm
7373-1	126.5	137	126.5	345	23	-
7373-2	126.5	287	126.5	345	23	-
7373-3	126.5	287	126.5	345	23	-
7373-4	126.5	467	126.5	345	23	233.5
7373-5	126.5	467	126.5	345	23	233.5
7373-6	126.5	617	126.5	345	23	308.5
7373-7	126.5	617	126.5	345	23	308.5
7373-9	126.5	917	126.5	345	23	458.5